

P:\Y-2024\2024\_0287\SURVEY\CORE SURVEY\DRAWINGS\03\_2024\_PCC DOCKSIOD 7 OIL DOCK\_7\_18SEPT2024.DWG

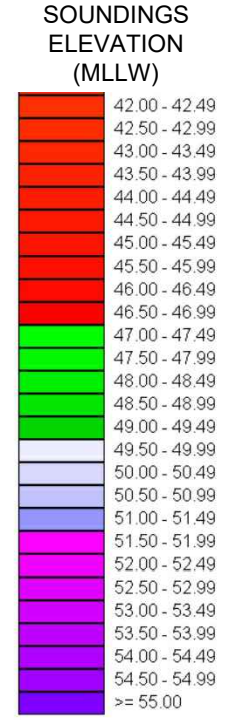

I CERTIFY THAT THIS SURVEY WAS CONDUCTED UNDER MY DIRECTION AND SUPERVISION.

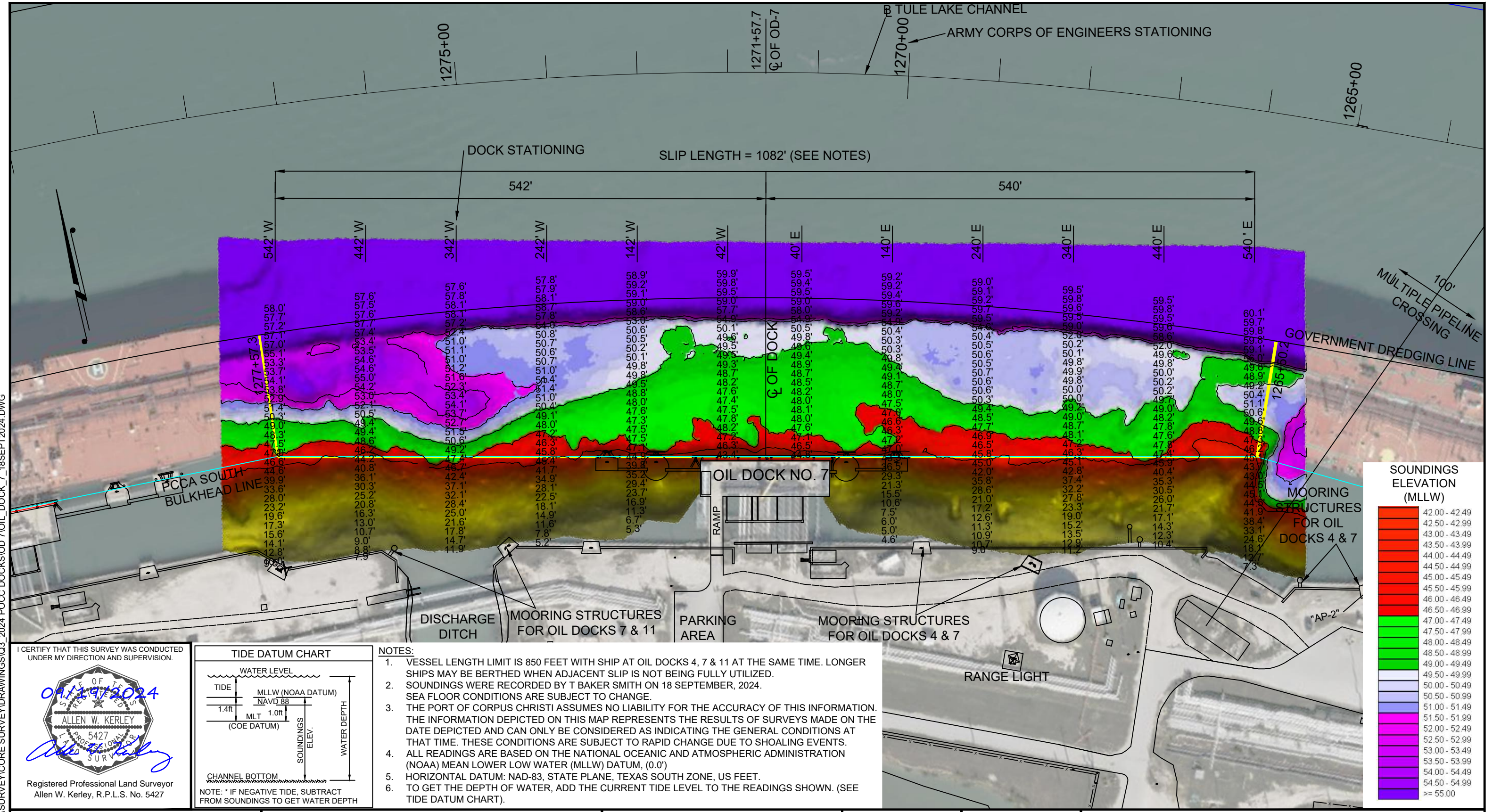
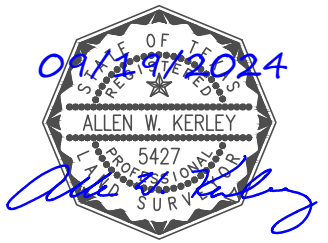

Registered Professional Land Surveyor  
Allen W. Kerley, R.P.L.S. No. 5427

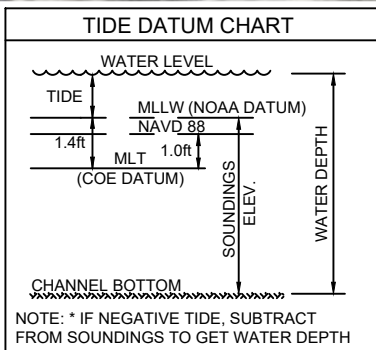

- NOTES:**
1. VESSEL LENGTH LIMIT IS 850 FEET WITH SHIP AT OIL DOCKS 4, 7 & 11 AT THE SAME TIME. LONGER SHIPS MAY BE BERTHED WHEN ADJACENT SLIP IS NOT BEING FULLY UTILIZED.
  2. SOUNDINGS WERE RECORDED BY T BAKER SMITH ON 18 SEPTEMBER, 2024. SEA FLOOR CONDITIONS ARE SUBJECT TO CHANGE.
  3. THE PORT OF CORPUS CHRISTI ASSUMES NO LIABILITY FOR THE ACCURACY OF THIS INFORMATION. THE INFORMATION DEPICTED ON THIS MAP REPRESENTS THE RESULTS OF SURVEYS MADE ON THE DATE DEPICTED AND CAN ONLY BE CONSIDERED AS INDICATING THE GENERAL CONDITIONS AT THAT TIME. THESE CONDITIONS ARE SUBJECT TO RAPID CHANGE DUE TO SHOALING EVENTS.
  4. ALL READINGS ARE BASED ON THE NATIONAL OCEANIC AND ATMOSPHERIC ADMINISTRATION (NOAA) MEAN LOWER LOW WATER (MLLW) DATUM, (0.0')
  5. HORIZONTAL DATUM: NAD-83, STATE PLANE, TEXAS SOUTH ZONE, US FEET.
  6. TO GET THE DEPTH OF WATER, ADD THE CURRENT TIDE LEVEL TO THE READINGS SHOWN. (SEE TIDE DATUM CHART).



**T. BAKER SMITH**  
A CENTURY OF SOLUTIONS  
3854 FM 1069  
Aransas Pass, TX 78336  
(361)334-5719 - tbsmith.com  
TBPLS #10194575

SCALE: 1" = 100'

REV. NO: 00    REV. DATE: --/--    REV. BY: --  
REVISION DESCRIPTION: --

DRAWN BY:	CDW	APPROVED BY:	AWK
DATE:	09/19/2024	JOB NO:	2024.0287
DRAWING NAME:	OIL DOCK 7 18SEPT2024		
PROJECTION:	TEXAS STATE PLANE SOUTH ZONE		
GEO. DATUM:	NAD83 (2011)   VERT. DATUM: NAVD88		
GRID UNITS:	US SURVEY FEET		
SHEET NO:	1	OF	1

**PORT OF CORPUS CHRISTI AUTHORITY**

**OIL DOCK 7**  
SOUNDINGS  
AN EXHIBIT OF A  
BATHYMETRIC SURVEY  
LOCATED IN  
CORPUS CHRISTI, TEXAS