

--- - P:\Y-2025\2025.0225\DRAWINGS\Q2 DOCKS\1-COMPLETED\OD11\OIL\_DOCK\_11\_10JUNE2025.DWG

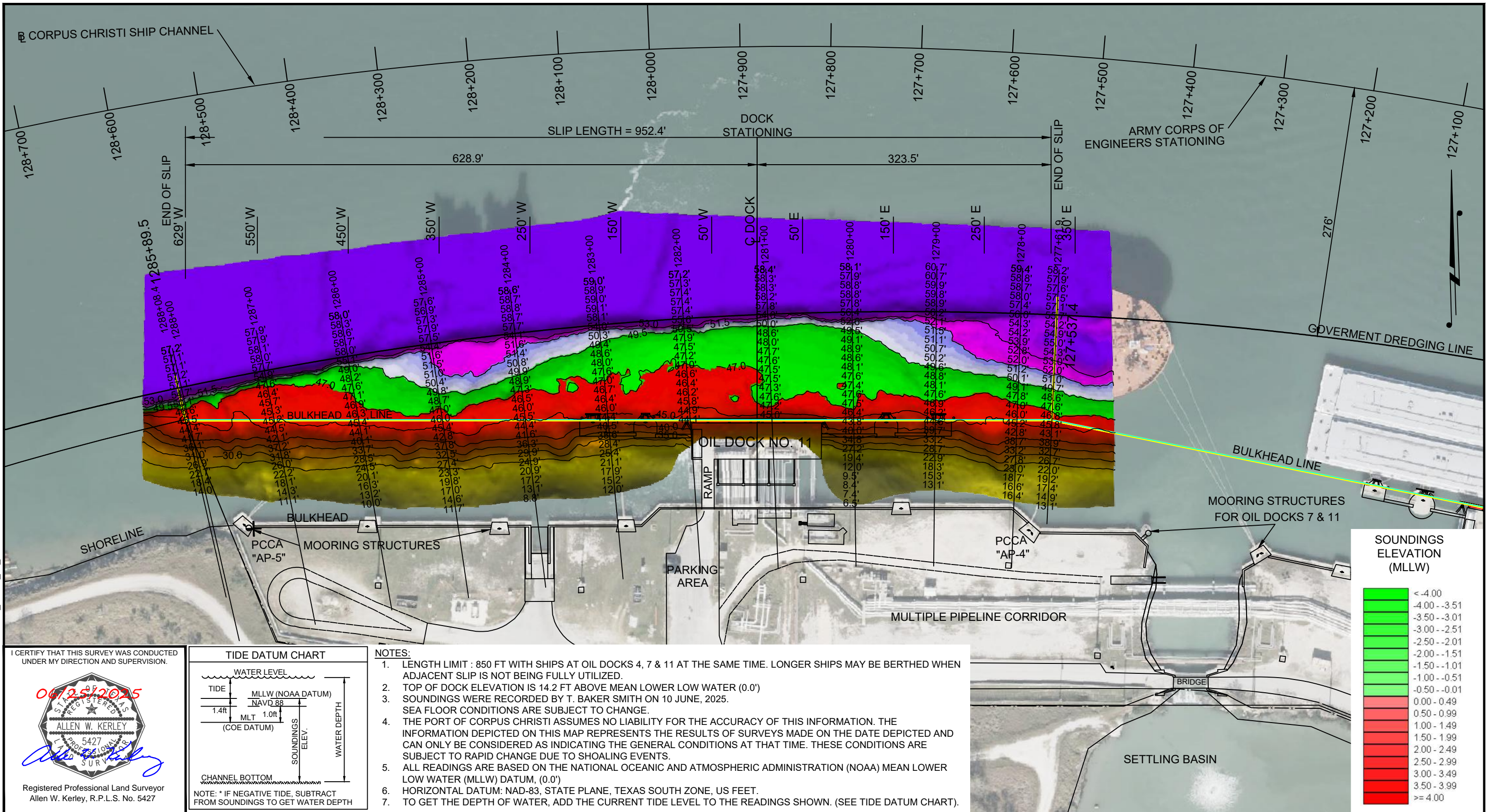

I CERTIFY THAT THIS SURVEY WAS CONDUCTED UNDER MY DIRECTION AND SUPERVISION.



Registered Professional Land Surveyor  
Allen W. Kerley, R.P.L.S. No. 5427

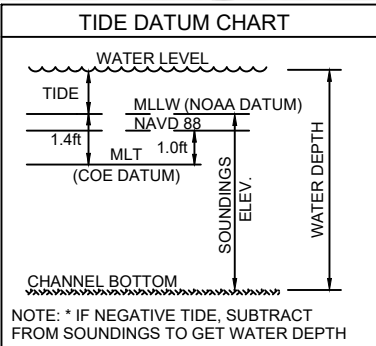

**NOTES:**

1. LENGTH LIMIT : 850 FT WITH SHIPS AT OIL DOCKS 4, 7 & 11 AT THE SAME TIME. LONGER SHIPS MAY BE BERTHED WHEN ADJACENT SLIP IS NOT BEING FULLY UTILIZED.
2. TOP OF DOCK ELEVATION IS 14.2 FT ABOVE MEAN LOWER LOW WATER (0.0')
3. SOUNDINGS WERE RECORDED BY T. BAKER SMITH ON 10 JUNE, 2025.
4. SEA FLOOR CONDITIONS ARE SUBJECT TO CHANGE.
5. THE PORT OF CORPUS CHRISTI ASSUMES NO LIABILITY FOR THE ACCURACY OF THIS INFORMATION. THE INFORMATION DEPICTED ON THIS MAP REPRESENTS THE RESULTS OF SURVEYS MADE ON THE DATE DEPICTED AND CAN ONLY BE CONSIDERED AS INDICATING THE GENERAL CONDITIONS AT THAT TIME. THESE CONDITIONS ARE SUBJECT TO RAPID CHANGE DUE TO SHOALING EVENTS.
6. ALL READINGS ARE BASED ON THE NATIONAL OCEANIC AND ATMOSPHERIC ADMINISTRATION (NOAA) MEAN LOWER LOW WATER (MLLW) DATUM, (0.0')
7. HORIZONTAL DATUM: NAD-83, STATE PLANE, TEXAS SOUTH ZONE, US FEET.
8. TO GET THE DEPTH OF WATER, ADD THE CURRENT TIDE LEVEL TO THE READINGS SHOWN. (SEE TIDE DATUM CHART).



**T. BAKER SMITH**  
A CENTURY OF SOLUTIONS  
3854 FM 1069  
Aransas Pass, TX 78336  
(361)334-5719 - tbsmith.com  
TBPLS #10194575

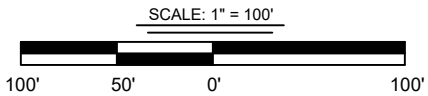

REV. NO: 00 REV. DATE: --/-- REV. BY: --  
REVISION DESCRIPTION: --

DRAWN BY: MES APPROVED BY: AWK  
DATE: 06/25/2025 JOB NO: 2025.0225  
DRAWING NAME: OIL\_DOCK\_11\_10JUNE2025  
PROJECTION: TEXAS STATE PLANE SOUTH ZONE  
GEO. DATUM: NAD83 (2011) | VERT. DATUM: NAVD88  
GRID UNITS: US SURVEY FEET  
SHEET NO: 1 OF 1

PORT OF CORPUS CHRISTI AUTHORITY

OIL DOCK 11  
SOUNDINGS  
AN EXHIBIT OF A  
BATHYMETRIC SURVEY  
LOCATED IN  
CORPUS CHRISTI, TEXAS