

SOUNDING
ELEVATION
(MLLW)

C CORPUS CHRISTI TURNING BASIN

ARMY CORPS
OF ENGINEERS
STATIONING

400FT

GOVERNMENT DREDGING LINE

BULKHEAD LINE

CARGO DOCK 8

BULKHEAD

MOORING
STRUCTURE

DOCK COORDINATES
STATE PLANE, NAD-83, TEXAS SOUTH, US FEET

POINT	NORTHING	EASTING	DESCRIPTION
1	17185513.7	1338243.7	DOCK CORNER
2	17185533.7	1339108.2	DOCK CORNER

I CERTIFY THAT THIS SURVEY WAS CONDUCTED
UNDER MY DIRECTION AND SUPERVISION.

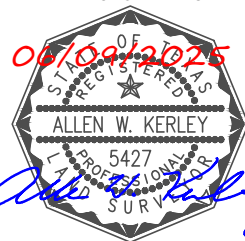

Registered Professional Land Surveyor
Allen W. Kerley, R.P.L.S. No. 5427

NOTES:

1. VESSEL LENGTH LIMIT IS 1060 FEET OR MORE IF ADJACENT BERTHS ARE UNOCCUPIED.
2. SOUNDINGS WERE RECORDED BY T BAKER SMITH ON 5 MAY, 2025.
SEA FLOOR CONDITIONS ARE SUBJECT TO CHANGE.
3. THE PORT OF CORPUS CHRISTI ASSUMES NO LIABILITY FOR THE ACCURACY OF THIS INFORMATION. THE
INFORMATION DEPICTED ON THIS MAP REPRESENTS THE RESULTS OF SURVEYS MADE ON THE DATE DEPICTED AND
CAN ONLY BE CONSIDERED AS INDICATING THE GENERAL CONDITIONS AT THAT TIME. THESE CONDITIONS ARE
SUBJECT TO RAPID CHANGE DUE TO SHOALING EVENTS.
4. ALL READINGS ARE BASED ON THE NATIONAL OCEANIC AND ATMOSPHERIC ADMINISTRATION (NOAA) MEAN LOWER
LOW WATER (MLLW) DATUM, (0.0')
5. HORIZONTAL DATUM: NAD-83, STATE PLANE, TEXAS SOUTH ZONE, US FEET.
6. TO GET THE DEPTH OF WATER, ADD THE CURRENT TIDE LEVEL TO THE READINGS SHOWN.
(SEE TIDE DATUM CHART).

TIDE DATUM CHART

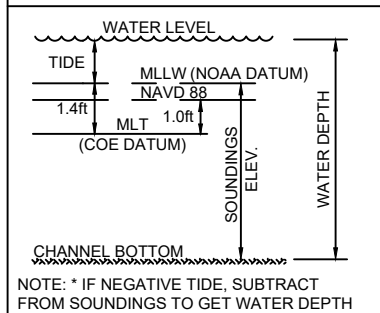

SCALE: 1" = 100'

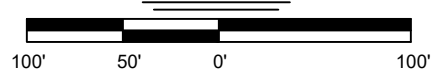

REV. NO: 00 REV. DATE: --/-- REV. BY: ---
REVISION DESCRIPTION:
--

DRAWN BY: MES APPROVED BY: AWK
DATE: 05/09/2025 JOB NO: 2025.0225
DRAWING NAME: CARGO DOCK 8 5MAY2025
PROJECTION: TEXAS STATE PLANE SOUTH ZONE
GEO. DATUM: NAD83 (2011) | VERT. DATUM: NAVD88
GRID UNITS: US SURVEY FEET
SHEET NO: 1 OF 1

PORT OF CORPUS CHRISTI AUTHORITY

CARGO DOCK 8
SOUNDINGS
AN EXHIBIT OF A
BATHYMETRIC SURVEY
LOCATED IN
CORPUS CHRISTI, TEXAS



T. BAKER SMITH
A CENTURY OF SOLUTIONS
3854 FM 1069
Aransas Pass, TX 78336
(361)334-5719 - tbsmith.com
TBPLS #10194575