

- NOTES:**
1. VESSEL LENGTH LIMIT: 1000 FEET OR MORE IF ADJACENT BERTHS ARE UNOCCUPIED.
  2. SOUNDINGS WERE RECORDED BY T BAKER SMITH ON 5 MARCH, 2025.  
SEA FLOOR CONDITIONS ARE SUBJECT TO CHANGE.
  3. THE PORT OF CORPUS CHRISTI ASSUMES NO LIABILITY FOR THE ACCURACY OF THIS INFORMATION.  
THE INFORMATION DEPICTED ON THIS MAP REPRESENTS THE RESULTS OF SURVEYS MADE ON THE DATE DEPICTED AND CAN ONLY BE CONSIDERED AS INDICATING THE GENERAL CONDITIONS AT THAT TIME. THESE CONDITIONS ARE SUBJECT TO RAPID CHANGE DUE TO SHOALING EVENTS.
  4. ALL READINGS ARE BASED ON THE NATIONAL OCEANIC AND ATMOSPHERIC ADMINISTRATION (NOAA) MEAN LOWER LOW WATER (MLLW) DATUM, (O.O')  
HORIZONTAL DATUM: NAD-83, STATE PLANE, TEXAS SOUTH ZONE, US FEET.
  5. TO GET THE DEPTH OF WATER, ADD THE CURRENT TIDE LEVEL TO THE READINGS SHOWN. (SEE TIDE DATUM CHART).

**♀ CORPUS CHRISTI TURNING BASIN**

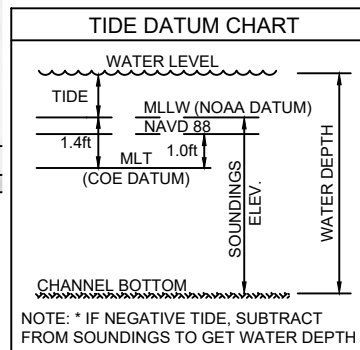
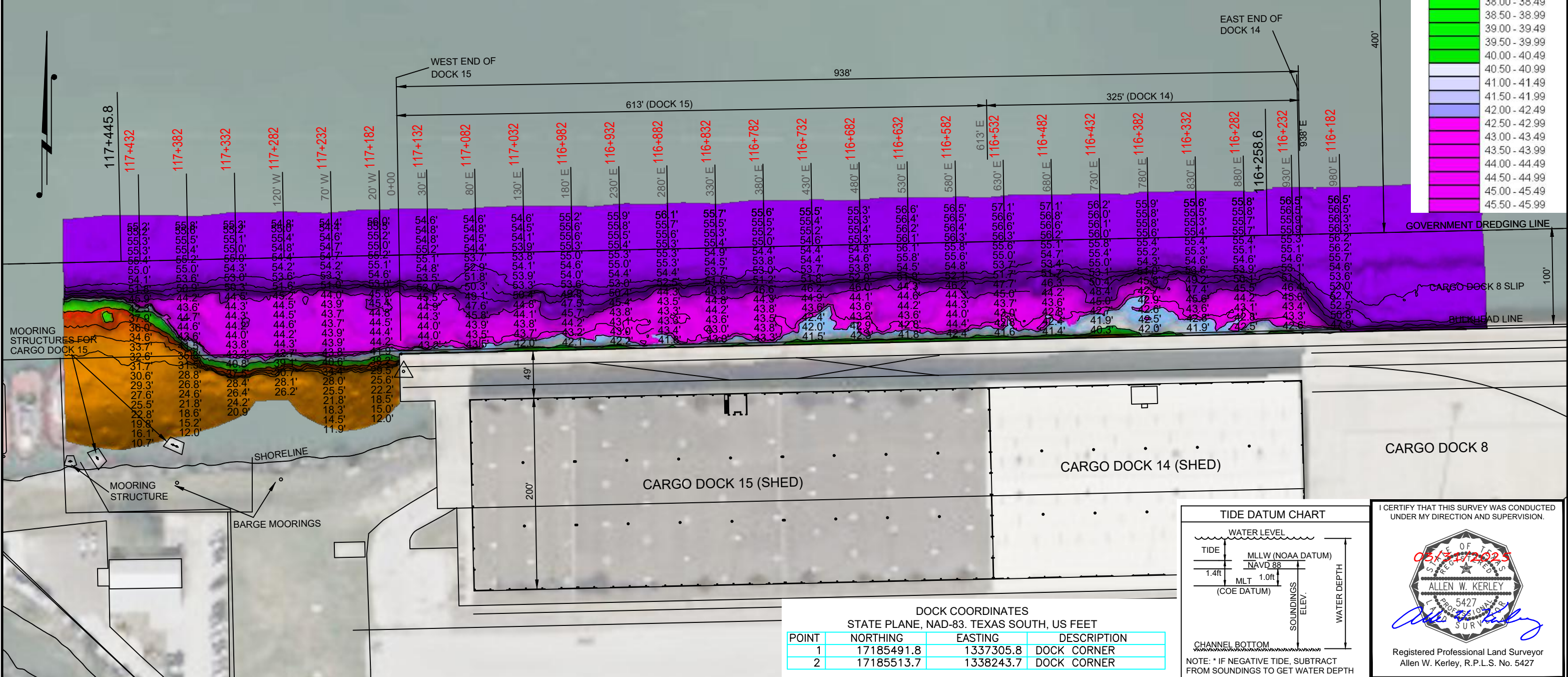
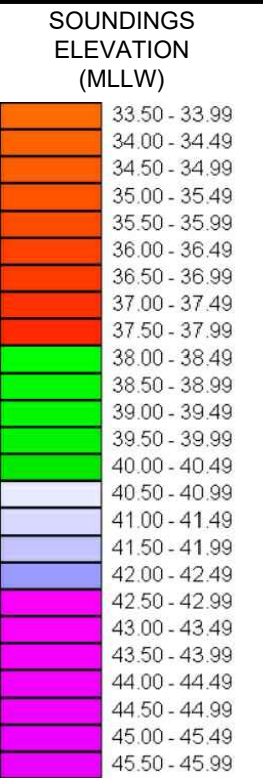

I CERTIFY THAT THIS SURVEY WAS CONDUCTED UNDER MY DIRECTION AND SUPERVISION.

Allen W. Kerley, R.P.L.S. No. 5427

**DOCK COORDINATES**  
STATE PLANE, NAD-83, TEXAS SOUTH, US FEET

POINT	NORTHING	EASTING	DESCRIPTION
1	17185491.8	1337305.8	DOCK CORNER
2	17185513.7	1338243.7	DOCK CORNER

P:\Y-2025\2025.0225\DRAWINGS\1 DOCKS\CD 14-15\CARGO\_DOCK\_14-15\_5MAR2025.DWG



**T. BAKER SMITH**  
A CENTURY OF SOLUTIONS  
3854 FM 1069  
Aransas Pass, TX 78336  
(361)334-5719 - tbsmith.com  
TBPLS #10194575

SCALE: 1" = 100'

REV. NO: 00    REV. DATE: --/--    REV. BY: --

REVISION DESCRIPTION: --

DRAWN BY: CDW	APPROVED BY: AWK
DATE: 03/27/2025	JOB NO: 2025.0225
DRAWING NAME: CARGO DOCK 14-15 5MAR2025	
PROJECTION: TEXAS STATE PLANE SOUTH ZONE GEO. DATUM: NAD83 (2011)   VERT. DATUM: NAVD88 GRID UNITS: US SURVEY FEET	
SHEET NO: 1	OF 1

**PORT OF CORPUS CHRISTI AUTHORITY**

**CARGO DOCK 14-15**  
SOUNDINGS  
AN EXHIBIT OF A  
BATHYMETRIC SURVEY  
LOCATED IN  
CORPUS CHRISTI, TEXAS