

NOTES:

1. SOUNDINGS WERE RECORDED BY T. BAKER SMITH ON 18 OCTOBER, 2021. SEA FLOOR CONDITIONS ARE SUBJECT TO CHANGE.
2. THE PORT OF CORPUS CHRISTI ASSUMES NO LIABILITY FOR THE ACCURACY OF THIS INFORMATION. THE INFORMATION DEPICTED ON THIS MAP REPRESENTS THE RESULTS OF SURVEYS MADE ON THE DATE DEPICTED AND CAN ONLY BE CONSIDERED AS INDICATING THE GENERAL CONDITIONS AT THAT TIME. THESE CONDITIONS ARE SUBJECT TO RAPID CHANGE DUE TO SHOALING EVENTS.
3. ALL READINGS ARE BASED ON THE NATIONAL OCEANIC AND ATMOSPHERIC ADMINISTRATION (NOAA) MEAN LOWER LOW WATER (MLLW) DATUM, (O.O')
4. ORIZONTAL DATUM: NAD-83, STATE PLANE, TEXAS SOUTH ZONE, US FEET.
5. TO GET THE DEPTH OF WATER, ADD THE CURRENT TIDE LEVEL TO THEREADINGS SHOWN. (SEE TIDE DATUM CHART).

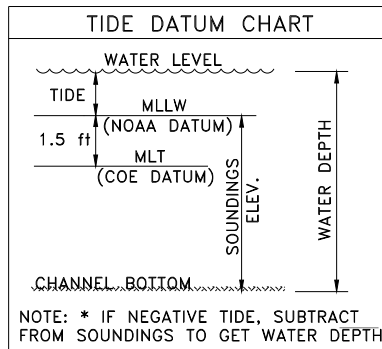

50 0 50 100 150 200 250 300  
SCALE: 1" = 100 FEET © 11" x 17"

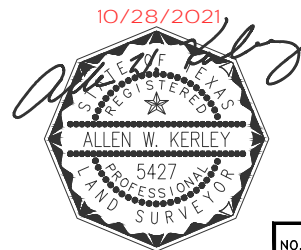

NO.	DATE	REVISION



PORT **CORPUSCHRISTI**



**T. BAKER SMITH**  
A CENTURY OF SOLUTIONS  
3854 FM 1069  
Aransas Pass, TX 78336  
(361)334-5719 - tbsmith.com  
TBPLS #10194575

PORT OF CORPUS CHRISTI AUTHORITY

SOUNDINGS  
CARGO DOCK 16

SCALE: 1" = 60'  
DWN. BY: CDW

PLAN

DATE:  
OCT. 2021