

**NOTES:**

1. VESSEL LENGTH LIMIT IS 1000 FEET.
2. SOUNDINGS WERE RECORDED BY T BAKER SMITH ON 9 OCTOBER, 2021. SEA FLOOR CONDITIONS ARE SUBJECT TO CHANGE.
3. THE PORT OF CORPUS CHRISTI ASSUMES NO LIABILITY FOR THE ACCURACY OF THIS INFORMATION. THE INFORMATION DEPICTED ON THIS MAP REPRESENTS THE RESULTS OF SURVEYS MADE ON THE DATE DEPICTED AND CAN ONLY BE CONSIDERED AS INDICATING THE GENERAL CONDITIONS AT THAT TIME. THESE CONDITIONS ARE SUBJECT TO RAPID CHANGE DUE TO SHOALING EVENTS.
4. ALL READINGS ARE BASED ON THE NATIONAL OCEANIC AND ATMOSPHERIC ADMINISTRATION (NOAA) MEAN LOWER LOW WATER (MLLW) DATUM, (0.0')
5. HORIZONTAL DATUM: NAD-83, STATE PLANE, TEXAS SOUTH ZONE, US FEET.
6. TO GET THE DEPTH OF WATER, ADD THE CURRENT TIDE LEVEL TO THE READINGS SHOWN. (SEE TIDE DATUM CHART).

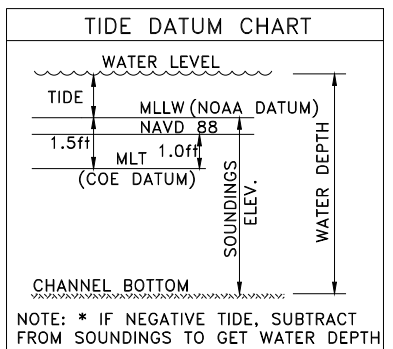
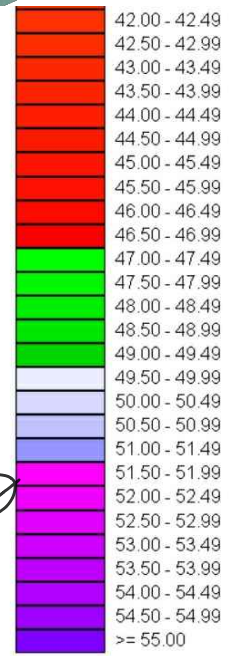
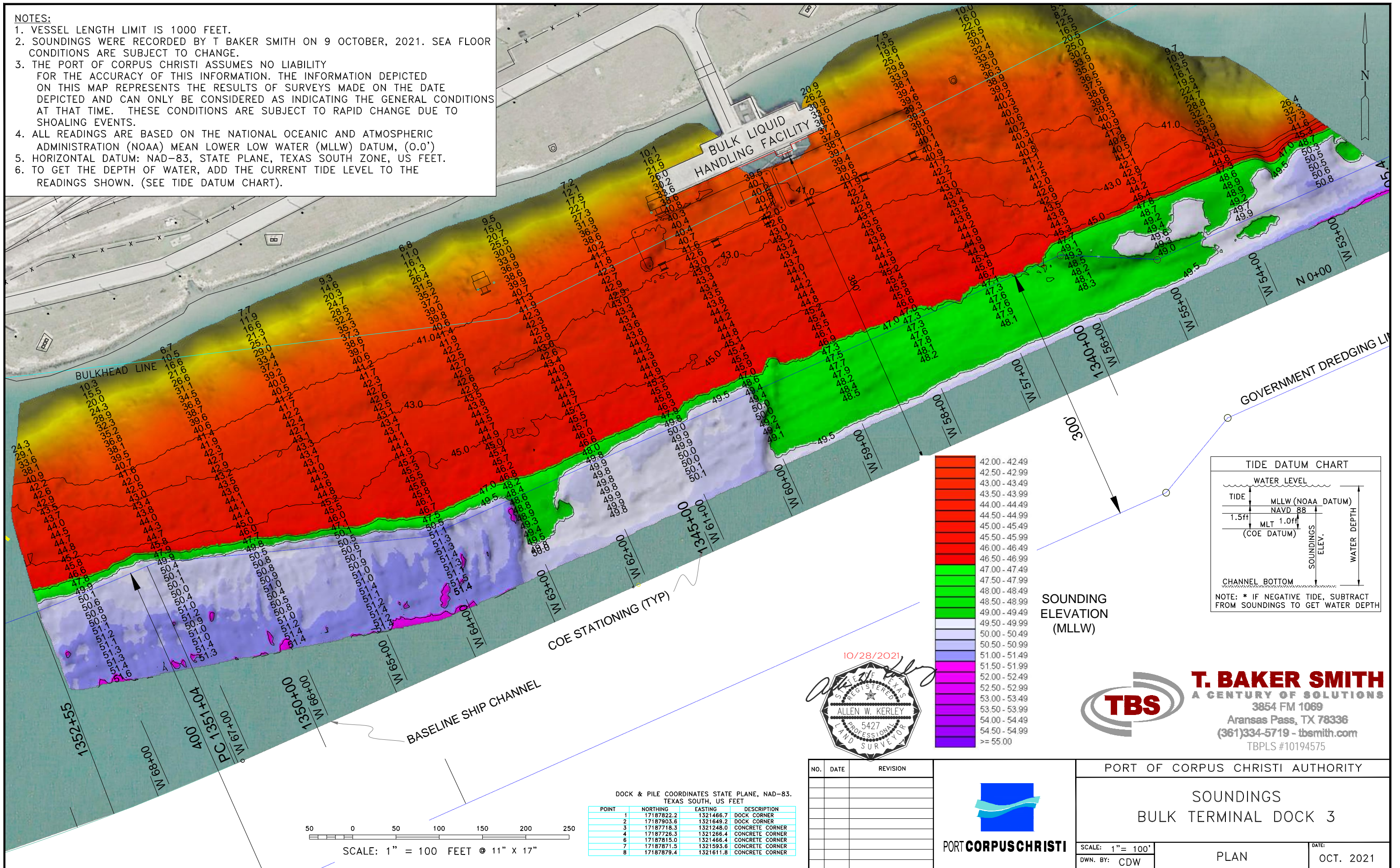

COE STATIONING (TYP)

BASELINE SHIP CHANNEL

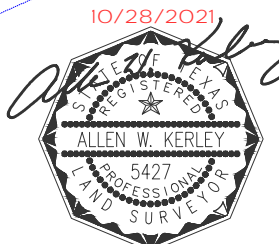

**TBS**  
**T. BAKER SMITH**  
 A CENTURY OF SOLUTIONS  
 3854 FM 1069  
 Aransas Pass, TX 78336  
 (361)334-5719 - tbsmith.com  
 TBPLS #10194575

DOCK & PILE COORDINATES STATE PLANE, NAD-83, TEXAS SOUTH, US FEET

POINT	NORTHING	EASTING	DESCRIPTION
1	17187822.2	1321466.7	DOCK CORNER
2	17187903.6	1321649.2	DOCK CORNER
3	17187718.3	1321248.0	CONCRETE CORNER
4	17187728.3	1321266.4	CONCRETE CORNER
6	17187815.0	1321466.4	CONCRETE CORNER
7	17187871.5	1321593.6	CONCRETE CORNER
8	17187879.4	1321611.8	CONCRETE CORNER

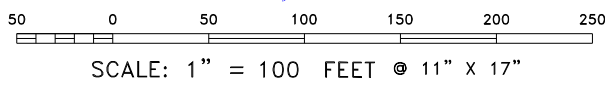

NO.	DATE	REVISION

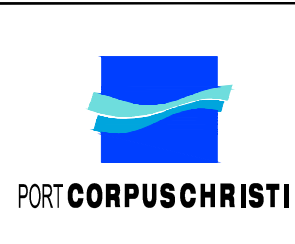

PORT OF CORPUS CHRISTI AUTHORITY

**SOUNDINGS**  
**BULK TERMINAL DOCK 3**

SCALE: 1" = 100'  
 DWN. BY: CDW

PLAN

DATE: OCT. 2021